

TM54XX Control panel user manual

I. Safety Instruction

- 1 For security, please read the instructions carefully before initial operation; making sure the power is off before connection.
- 2 Please clear the memory before initial operation. (Ref. Erasing ALL learned / memorized transmitters)
- 3 Do not learn the remote control when the motor is operating in order to avoid mis-operation.
- 4 The received signal may be interfered by other communication devices. (e.g. the wireless control system with the same frequency range)
- 5 It is forbidden to control the high-risk coefficient equipment / system. (e.g. cranes)
- 6 It is used only for the manual remote control and wireless control equipment / system which must not endanger life or property during running failure, or its security risks have been eliminated.

II. Technical parameters:

1. Working voltage: AC110V/AC220V, 50Hz/60Hz (It depends on the working voltage of motor)
2. Temperature range: -20°C to 60°C
3. Loading capacity: 1HP, 250V
4. Built-in fuse: No fuse
5. Working frequency: 433.92MHz
6. Weight :156g
7. Size: 130*35*20mm
8. Master transmitter can be learned automatically when power on, slave transmitter can be learned with master transmitter.
9. Press STOP and UP button of master transmitter for about 8 seconds can change the running direction of motor.
10. Press STOP and DOWN button of master transmitter for about 8 seconds can adjust the max running time of motor.

III. Connection Instruction

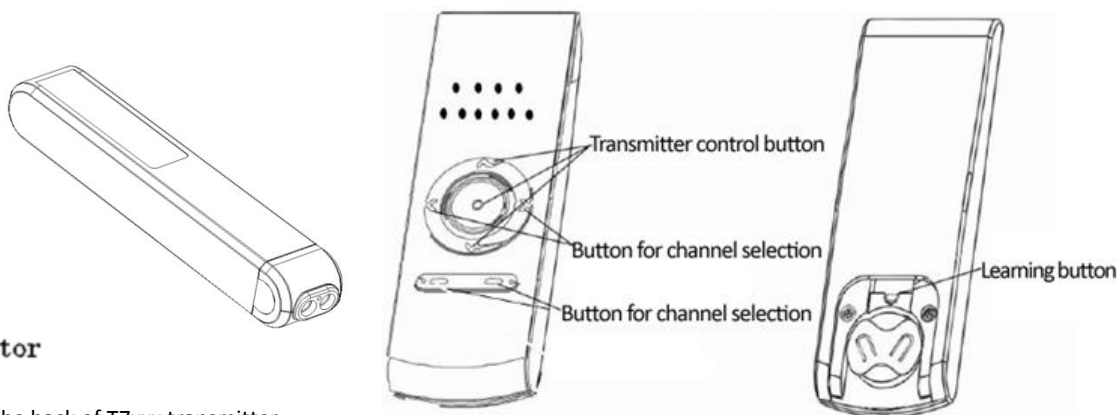
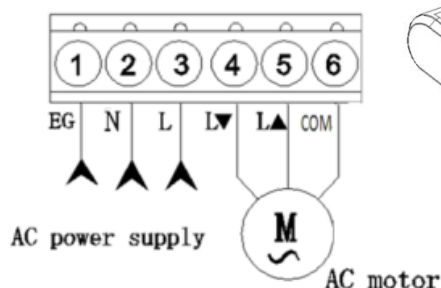

IV. Operation Instruction

1. Learning button is the button on the back of T7xxx transmitter.
2. Learning master transmitter: Keep pressing the learning button of T7xxx and power on the controller, after approximately 3S, the buzzer rings and motor shake twice. Then release the learning button, buzzer rings and shakes for three times. This new transmitter has been recorded as master transmitter into the controller. At the same time it cleans all other transmitters that recorded before.
3. Learning slave transmitters by master transmitter:
 - A. Enters learning process: Keep pressing the learning button for 3 seconds, buzzer rings slowly, motor shakes for 1 time. Release learning button, buzzer stops, motor shakes for 3 times. Controller enters learning process.
 - B. Learning slave transmitter: Keep pressing the learning button for 3 seconds, buzzer rings slowly, motor shakes for 1 time. Release learning button, buzzer keeps ringing, motor shakes for 3 times. This new transmitter has been recorded as slave transmitter into the controller. After that, controller quit the learning process. (Motor will not shake if the controller already has learned enough transmitters or this transmitter already had been learned)
 - C. Learning master transmitter: Keep pressing the learning button for 8 seconds, buzzer rings slowly, motor shakes for 1 time. After 8 seconds, buzzer rings quickly, motor shakes for 2 times. Release learning button, buzzer keeps ringing, motor shakes for 3 times. This new transmitter has been recorded as master transmitter into the controller. After that, controller quit the learning process.
 - D. Erasing slave transmitters: Keep pressing the learning button for 8 seconds, buzzer rings slowly, motor shakes for 1 time. After 8 seconds, buzzer rings quickly, motor shakes for 2 times. Release learning button, buzzer keeps ringing, motor shakers for 3 times. All slave transmitters have been erased and controller quit the learning process after that.
4. Set up motor running direction: Keep pressing master transmitter button "STOP+UP" together for 8 seconds, buzzer rings quickly, motor shakes for 2 times. Release the learning button, buzzer keeps ringing, motor shakes for 3 times. The running direction of motor has been changed.
5. Set up max running time: Keep pressing master transmitter button "STOP+DOWN" together for 3 seconds, buzzer rings slowly. Release the learning button after setting time, buzzer keeps ringing, motor shakes for 3 times. The running time of motor has been set. (time between 3-100S is available for setting, >100S is regarded as 100S, <3S is failing.)

V. Model list

Model	TM5401	TM5411	TM5403	TM5413	TM5405	TM5415	TM5407	TM5417
Color	White	Black	White	Black	White	Black	White	Black
Code	Rolling code	Rolling code	Fixed code	Fixed code	Rolling code	Rolling code	Fixed code	Fixed code
Voltage	220VAC	220VAC	220VAC	220VAC	110VAC	110VAC	110VAC	110VAC
Transmitter Stored	30	30	60	60	30	30	60	60

I. Technical parameters:

1. Working voltage:AC110V/AC220V, 50Hz/60Hz (It depends on the working voltage of motor)
2. Temperature range: -20°C to 60°C
3. Loading capacity: 1HP, 250V
4. Built-in fuse: No fuse
5. Working frequency: 433.92MHz
6. Weight :156g
- 7.Size: 130*35*20mm
8. Master transmitter can be learned automatically when power on, slave transmitter can be learned with master transmitter.
9. Press 1 and 2 button of master transmitter at the same time for about 8 seconds can change the running direction of motor.
10. The max running time of motor:100S

II. Connection Instruction

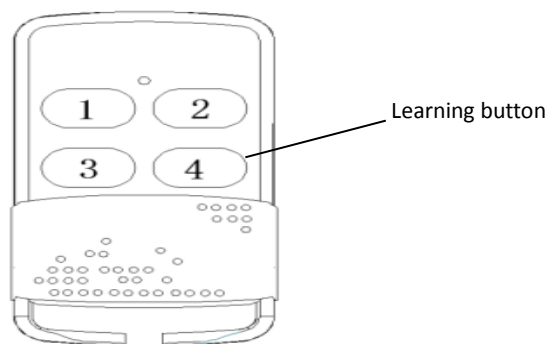
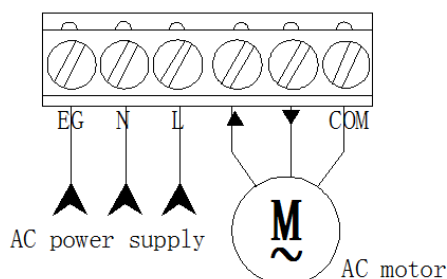

III. Operation Instruction

1. Learning button is the button 4 of T6xxx transmitter.
2. Learning master transmitter: Keep pressing the learning button of T6xxx and power on the controller, after approximately 3S, the buzzer rings and motor shake twice. Then release the learning button, buzzer rings and shakes for three times. This new transmitter has been recorded as master transmitter into the controller. At the same time it cleans all other transmitters that recorded before .
3. Learning slave transmitters by master transmitter:
 - E. Enters learning process: Keep pressing the learning button for 3 seconds, buzzer rings slowly, motor shakes for 1 time. Release learning button, buzzer stops, motor shakes for 3 times. Controller enters learning process.
 - F. Learning slave transmitter: Keep pressing the learning button for 3 seconds, buzzer rings slowly, motor shakes for 1 time. Release learning button, buzzer keeps ringing, motor shakes for 3 times. This new transmitter has been recorded as slave transmitter into the controller. After that, controller quit the learning process. (Motor will not shake if the controller already has learned enough transmitters or this transmitter already had been learned)
 - G. Learning master transmitter: Keep pressing the learning button for 8 seconds, buzzer rings slowly, motor shakes for 1 time. After 8 seconds, buzzer rings quickly, motor shakes for 2 times. Release learning button, buzzer keeps ringing, motor shakes for 3 times. This new transmitter has been recorded as master transmitter into the controller. After that, controller quit the learning process.
 - H. Erasing slave transmitters: Keep pressing the learning button for 8 seconds, buzzer rings slowly, motor shakes for 1 time. After 8 seconds, buzzer rings quickly, motor shakes for 2 times. Release learning button, buzzer keeps ringing, motor shakers for 3 times. All slave transmitters have been erased and controller quit the learning process after that.
4. Set up motor running direction: Keep pressing master transmitter button "1+2" together for 8 seconds, buzzer rings quickly, motor shakes for 2 times. Release the learning button, buzzer keeps ringing, motor shakes for 3 times. The running direction of motor has been changed.

V. Model list

Model	TM5401	TM5411	TM5403	TM5413	TM5405	TM5415	TM5407	TM5417
Color	White	Black	White	Black	White	Black	White	Black
Code	Rolling code	Rolling code	Fixed code	Fixed code	Rolling code	Rolling code	Fixed code	Fixed code
Voltage	220VAC	220VAC	220VAC	220VAC	110VAC	110VAC	110VAC	110VAC
Transmitter Stored	30	30	60	60	30	30	60	60

The interpretation and ownership of this manual belong to Hiland company. Any change of The product can be without prior notice.